

**PLAN - RETAINING WALL 3**  
 SCALE: 1/8" = 1'-0"

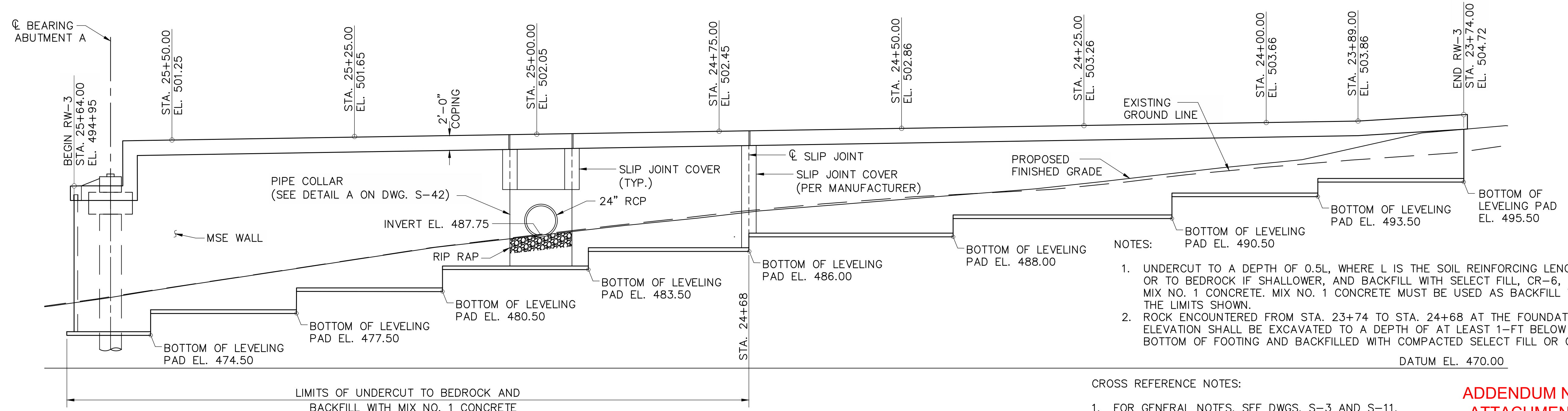

**ELEVATION - RETAINING WALL 3**  
 SCALE: 1/8" = 1'-0"

- NOTES:
- UNDERCUT TO A DEPTH OF 0.5L, WHERE L IS THE SOIL REINFORCING LENGTH, OR TO BEDROCK IF SHALLOWER, AND BACKFILL WITH SELECT FILL, CR-6, OR MIX NO. 1 CONCRETE. MIX NO. 1 CONCRETE MUST BE USED AS BACKFILL WITHIN THE LIMITS SHOWN.
  - ROCK ENCOUNTERED FROM STA. 23+74 TO STA. 24+68 AT THE FOUNDATION ELEVATION SHALL BE EXCAVATED TO A DEPTH OF AT LEAST 1'-FT BELOW BOTTOM OF FOOTING AND BACKFILLED WITH COMPACTED SELECT FILL OR CR-6.
- DATUM EL. 470.00

- CROSS REFERENCE NOTES:
- FOR GENERAL NOTES, SEE DWGS. S-3 AND S-11.
  - FOR SECTIONS, SEE DWGS. S-11 AND S-12.
  - FOR STORM DRAIN INFORMATION, SEE DWGS. SD-01 AND SD-05.

**ADDENDUM NO. 1**  
**ATTACHMENT C**  
 Sheet 3 of 4

DRAWING  
**S-10**

R:\Projects\2019\19041\19041.dwg  
 Date: 4/11/2019  
 User: jsw  
 Plot Date: 4/11/2019  
 Plot Time: 10:00 AM  
 Plot Scale: 1/8" = 1'-0"  
 Plot By: jsw  
 Plot Device: HPGL  
 Plot Path: \\server\plotters\HPGL

NO.	REVISION DESCRIPTION	BY	DATE
DESIGNED BY:	JSW	DRAWN BY:	MMB
CHECKED BY:	JSW	DATE:	APRIL 2019

**WASHINGTON COUNTY, MARYLAND**  
 DIVISION OF ENGINEERING  
 Washington County Administrative Annex, Building  
 80 W. Baltimore St., Hagerstown, MD 21740  
 Phone: 240-313-2460 Fax: 240-313-2401

**PROFESSIONAL BOULEVARD**  
**BRIDGE OVER ANTIETAM CREEK**  
**RETAINING WALL NO. 3**  
**PLAN AND ELEVATION**

STATE OF MARYLAND  
 PROFESSIONAL ENGINEER  
 No. 22484  
 JAMES W. JOHNSON

SCALE	1/8" = 1'-0"
SHEET NO.	38 OF 145
PROJECT NO.	10-244



S:\Proj\_Hwy\Co.W - Professional Boulevard\Civil 3D\Avt\ES-09\_P11.dwg

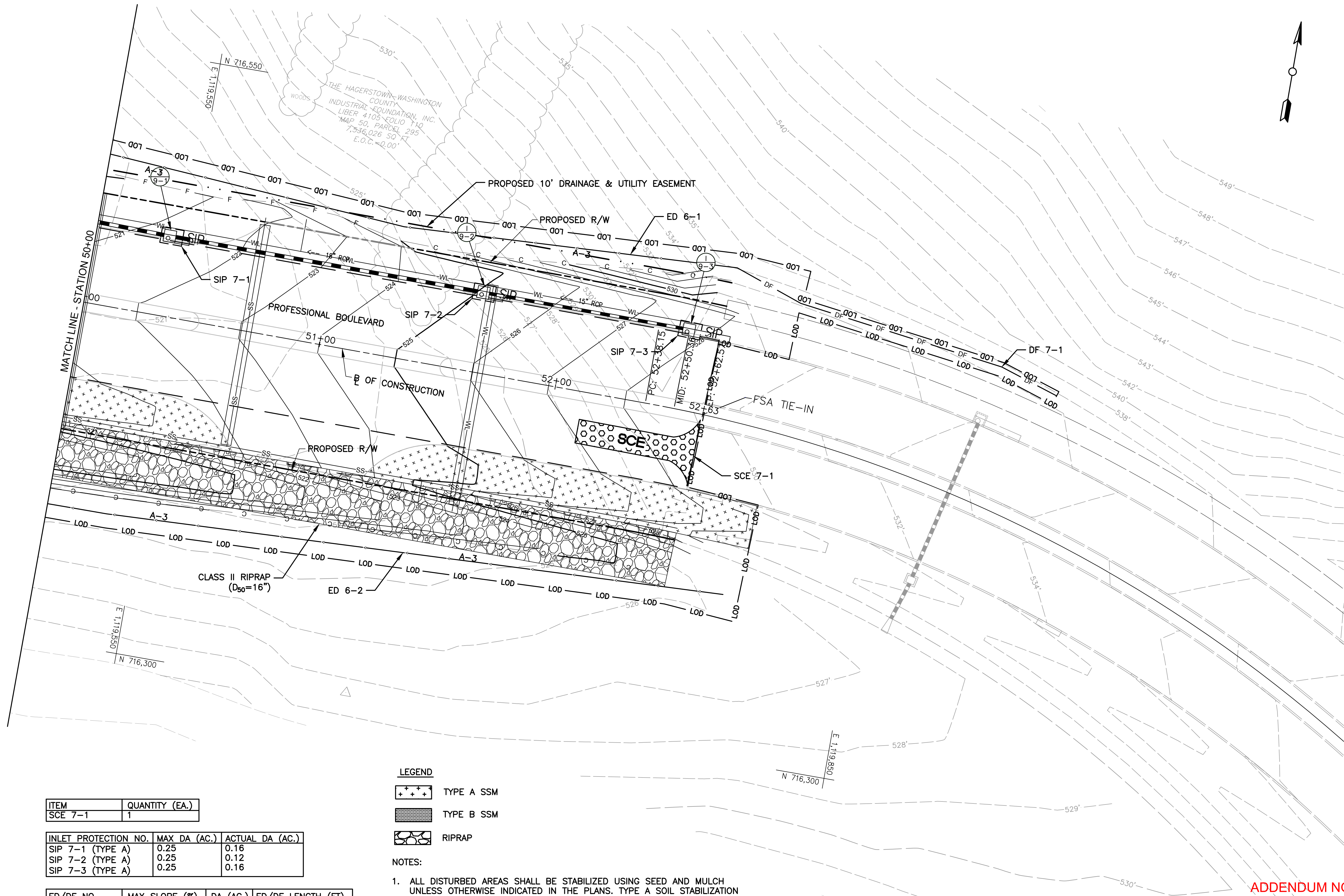
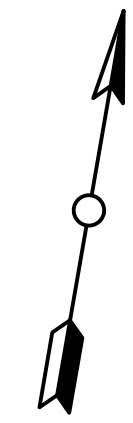

ITEM	QUANTITY (EA.)
SCE 7-1	1

INLET PROTECTION NO.	MAX DA (AC.)	ACTUAL DA (AC.)
SIP 7-1 (TYPE A)	0.25	0.16
SIP 7-2 (TYPE A)	0.25	0.12
SIP 7-3 (TYPE A)	0.25	0.16

ED/DF NO.	MAX SLOPE (%)	DA (AC.)	ED/DF LENGTH (FT)
DF 7-1	8	0.73	145

**LEGEND**

- TYPE A SSM
- TYPE B SSM
- RIPRAP

**NOTES:**

- ALL DISTURBED AREAS SHALL BE STABILIZED USING SEED AND MULCH UNLESS OTHERWISE INDICATED IN THE PLANS. TYPE A SOIL STABILIZATION MATTING SHALL BE USED ON ALL SLOPES 3:1 OR GREATER.
- DISTURBED AREAS SHALL BE STABILIZED IN ACCORDANCE WITH THE GENERAL NOTES AND SCHEDULES ON DRAWING EN-01.
- SEE LANDSCAPE PLANS FOR PROPOSED PERMANENT GROUNDCOVER.

**ADDENDUM NO. 1**  
**ATTACHMENT C**  
 Sheet 4 of 4



DRAWING  
ES-07

NO.	REVISION DESCRIPTION	BY	DATE

DESIGNED BY: IMS  
 DRAWN BY: IMS  
 CHECKED BY: BGB  
 DATE: APRIL 2019

WASHINGTON COUNTY, MARYLAND  
 DIVISION OF ENGINEERING

Washington County Administrative Annex, Building  
 80 W. Baltimore St., Hagerstown, MD 21740  
 Phone: 240-313-2460 Fax: 240-313-2401

**PROFESSIONAL BOULEVARD  
 BRIDGE OVER ANTIETAM CREEK  
 EROSION AND SEDIMENT  
 CONTROL PLAN**

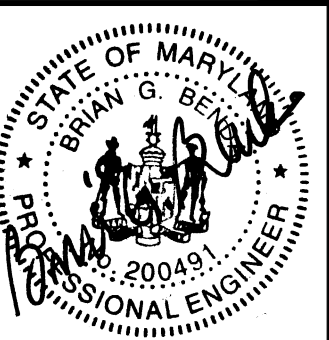

SCALE  
1"=20'

SHEET NO.  
95 OF 145

PROJECT NO.  
10-244